

KL-F01-P/PS Series

경하중용 - Light load

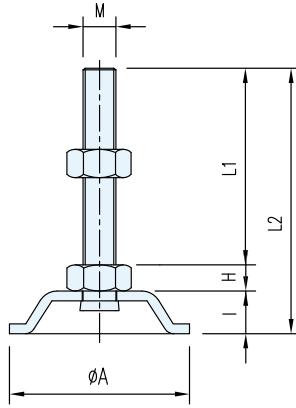

- **제품특징 Feature**
저가형, 경하중용
(Competitive price, Light load)
- **적용범위 Application**
컨베이어, 공작기계, 경하중용 설비
(Conveyor, Construction machine, Light duty equipment)

규격 - Dimension & Material

Unit: mm

Model	Dimension (mm)						Road (Kg/4EA)	Material		Treatment
	M	L1	L2	H	I	ØA		Bolt & Nut	Cup	
KL-F01-P (Steel) KL-F01-PS (STS)	M6x1.0	40	55	6	9	Ø36	100	S10C STS304	SPC STS304	Ni Natural/PL
	M8x1.25	40	55				200			
	M10x1.5	60	82	7	15	Ø50	300			
		100	122				500			
	M12x1.75	70	93	8	15	Ø63	500			
		100	123				600			
		130	153							
		150	173							
	M12x1.75	70	93	10	17	Ø75				
		100	123				800			
		130	153							
		150	173							
	M16x2.0	50	75	13	22	Ø95				
		70	95				1,000			
		100	125							
		130	155							
		150	175							
		150	175							
	M16x2.0	50	77	13	22	Ø95				
		70	97				1,000			
100		127								
130		157								
150		177								
180		207								
200		227								
250		277								
M20x2.5	100	130	13	22	Ø95	1,000				
	130	160				1,500				
	150	180								
	180	210								
	200	230								
	250	280								
M20x2.5	100	135	13	22	Ø95		1,500			
	130	165				1,500				
	150	185								
	180	215								
	200	235								
	250	285								
M20x2.5	100	135	13	22	Ø95		1,500			
	130	165				1,500				
	150	185								
	180	215								

* 기타 특수사양은 주문제작함 (Particular case is Made-To-Order)