

KD-C14-1 Series

경,중하중 완충캐스터 - Light, heavy load buffer caster



- 허용 하중 Allowable load
210~360Kg/4ea
- 사용 온도 Temperature
-10 ~ 90° C

표기법 - Ordering Code

KD-C14	1	100	SF	B
Caster Series	Function No.	Serial Number	<ul style="list-style-type: none"> • SF : Swivel Flange • RF : Rigid Flange 	<ul style="list-style-type: none"> • B : Brake

특징 - Features

- 완충캐스터
Shock absorber caster
- 내식성, 내마모성 우수
Excellent corrosion and wear resistance
- 미려한 외관
A beautiful appearance

용도 - Application

- 완충을 요하는 운반대차
Shock absorbing carts
- 자동차 부품 운반구
Automobile part carrier
- 부식방지용 운반구
Anti-corrosion carrier

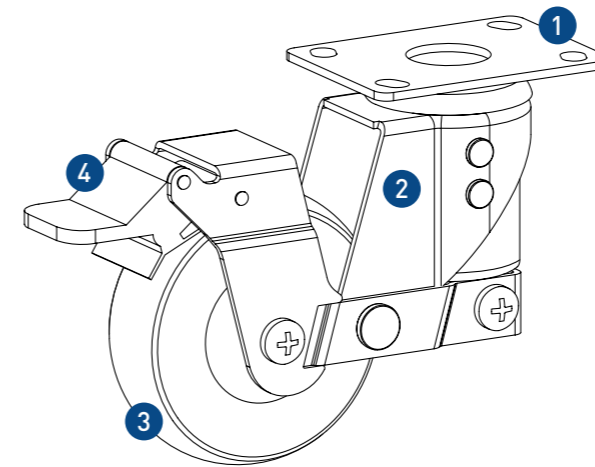

재질 & 표면처리 - Material & Treatment

NO.	재질	표면처리
① 상판(Top Plate)	STS	-
② 몸체(Body)	STS	-
③ 바퀴(Wheel)	Poly Urethane+PP	Light Gray
④ 브레이크(Brake)	PA	Purple

규격 - Dimension

Unit: mm

Model	자중 (Net Weight)	Kg		Ø		F			Hole	H	L	O
		1EA	4EA	Ø	W	F	F1	F2				
KD-C14-1-75RF-U	0.89										165	
KD-C14-1-75SF-U	0.89	70	210	Ø75	32	95x70	75x45	72x52	Ø9x13 (slot hole)	113.5 (-10)	165	80
KD-C14-1-75SFB-U	1.1										200	
KD-C14-1-100RF-U	0.99										181.5	
KD-C14-1-100SF-U	0.99	100	300	Ø100	32	95x70	75x45	72x52	Ø9x13 (slot hole)	138 (-12)	181.5	83
KD-C14-1-100SFB-U	1.19										213	
KD-C14-1-125RF-U	1.1										192.5	
KD-C14-1-125SF-U	1.39	120	360	Ø125	32	95x70	75x45	72x52	Ø9x13 (slot hole)	163 (-16)	192.5	81
KD-C14-1-125SFB-U	1.39										222.5	