

KD-C09-1 Series

중하중/저소음 캐스터 - Medium loads/Low noise Caster

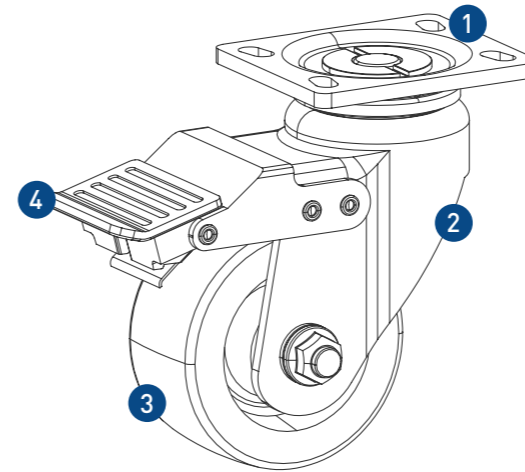

- 허용 하중 Allowable load
900~1,050Kg/4ea
- 사용 온도 Temperature
-10 ~ 90° C



재질 & 표면처리 - Material & Treatment

NO.	재질	표면처리
① 상판(Top Plate)	SPC	Black Coated
② 몸체(Body)	SPC	Black Coated
③ 바퀴(Wheel)	Poly Urethane+AL	-
④ 브레이크(Brake)	ABS	-

표기법 - Ordering Code

KD-C09	1	100	SF	B
Caster Series	Function No.	Serial Number	<ul style="list-style-type: none"> • SF : Swivel Flange • RF : Rigid Flange 	<ul style="list-style-type: none"> • B : Brake

특징 - Features

- 저소음, 저마찰
Low noise, low friction
- 중, 고하중용
For medium and high loads
- 선회력 우수
Excellent turning performance

용도 - Application

- 공정간 이송대차
Transfer loan between processes
- 각종 운반대차
A variety of cartwheels

규격 - Dimension

Unit: mm

Model	자중 (Net Weight)	Kg		Ø		F			Slot Hole	H	L	O
		1EA	4EA	Ø	W	F	F1	F2				
KD-C09-1-100RF-U	2.5										100	-
KD-C09-1-100SF-U	2.5	300	900	Ø100						157	150	50
KD-C09-1-100SFB-U	2.85										186	50
KD-C09-1-130RF-U	2.6										130	-
KD-C09-1-130SF-U	2.6	320	960	Ø130	40	100x85	80x60	77x45	Ø9x17L	186	165	50
KD-C09-1-130SFB-U	3										203	50
KD-C09-1-150RF-U	2.8										150	-
KD-C09-1-150SF-U	2.8	350	1,050	Ø150						206	175	50
KD-C09-1-150SFB-U	3.2										203	50