



## C-11 KC-106 딩플 록 - Dimple Lock



- 특징**
- 1Point 잠김.
  - 회전각 좌우 90°
  - 각 키 및 마스터 키 페이지 참조.
  - 좌, 우 별도입니다.
- 사양**
- 재질 : 아연 합금(ZDCII)
  - 표면처리 : 크롬 도금(MZCr)  
베로아 크롬 도금
  - 제품중량 : KC-106 : 38g
- 용도**
- 자판기, ATM, 정보 단말기, 중요 시설 등.

- Features**
- 1-Point locked structure.
  - Rotation angle - right 90°, left 90°
  - Refer to page for individual keys and master keys.
  - Use separately right and left.
- Specification**
- Materials Used : Zinc alloy(ZDCII)
  - Finish : Chrome plating(MZCr)  
Velour chrome plating
  - Weight : KC-106 : 38g
- Use**
- Vending machine, ATM, Information terminal, Important facilities, etc.

※ 락핸들 페이지 참고(p.532~549)  
※ 기본 락핸들 48번 사용

※ 제품내 락핸들 포함

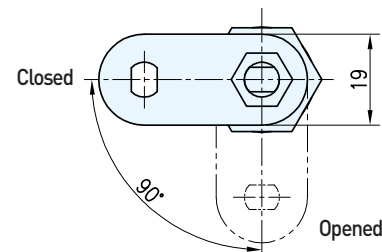
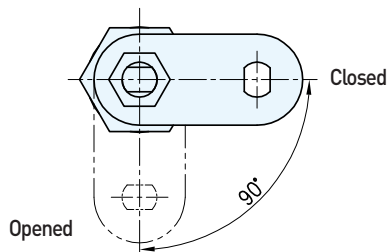
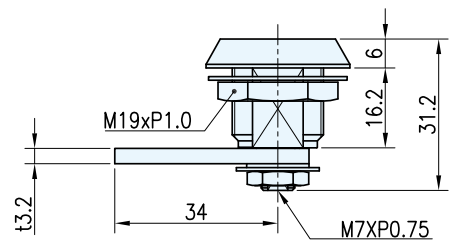
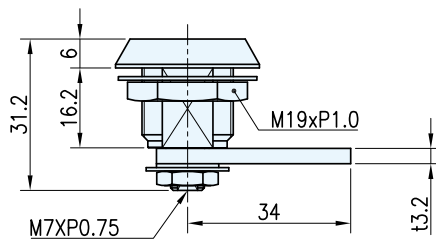
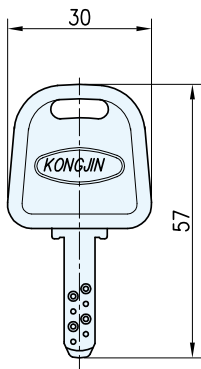
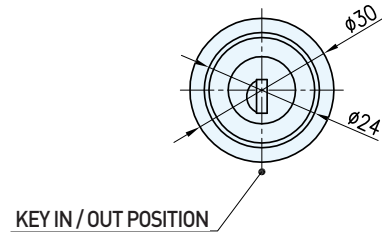
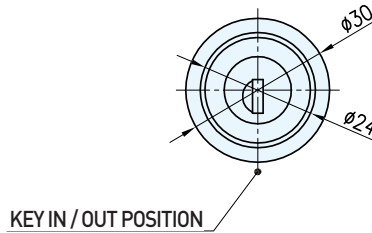
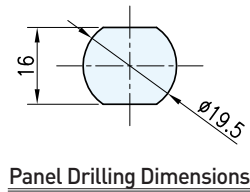
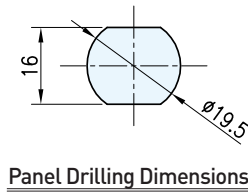
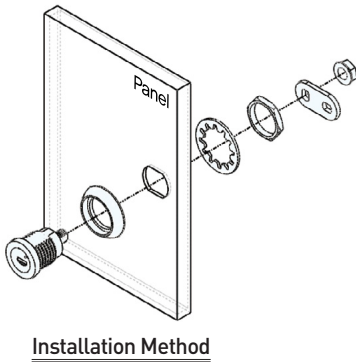

	코드번호
KC-106	KC00119